

COMET**NEWS**

EWM SERIES



MISTING PUMPS – LOW FLOW



The smart solution for misting applications
La miglior soluzione per le applicazioni da misting



S | Ø24 mm

TECHNICAL DATA / DATI TECNICI



GENERAL FEATURES

- Self priming pump
- High-strength brass pump head
- New designed reversible carter made in special aluminum alloy
- Stainless –steel hardened piston guides
- Special plugs for dust protection to protect the oil seal plunger
- O-ring and labyrinth oil seal system between crankcase and rear cover, to reduce oil splashing
- Wide oil level viewer
- Special aluminium alloy conrods made in a single piece
- Top-quality and oversized ball bearings to ensure long durability
- Highly efficient stainless steel check valves with removable plugs for easy inspection
- Solid ceramic plungers, high corrosion and abrasion-proof
- High performance double sealing system
- S 24mm solid shaft for Belt Drive, Gearbox or Flex Couplers or hollow shaft electric motor
- Ease of maintenance thanks to the reduced number of easily accessible components
- Oversized operation life thanks to the reduced loads and the kinematic mechanism created to support 280 bar.
- Stainless steel version with special seals resistant to chemical products







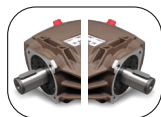
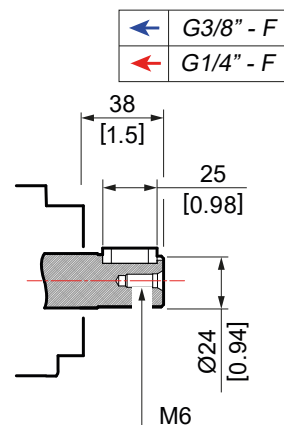
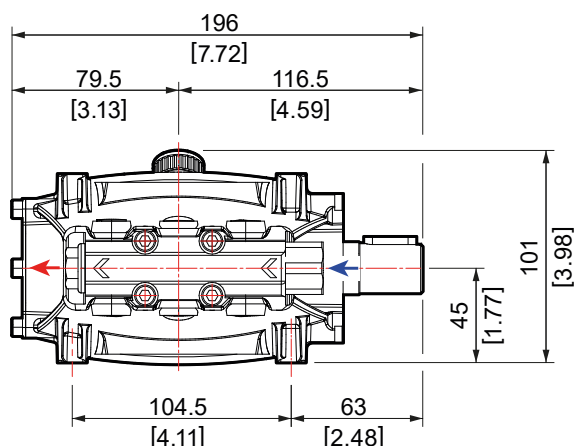
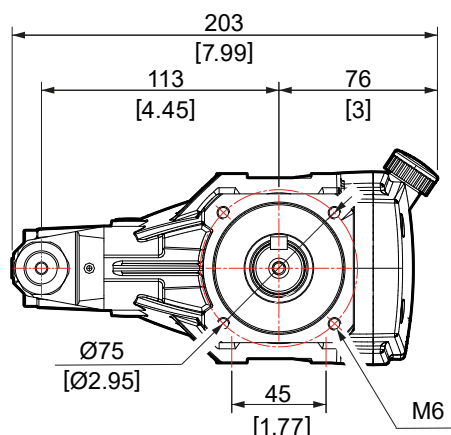

CARATTERISTICHE GENERALI

- Pompa autoadescante
- Testata pompa in ottone ad alta resistenza
- Carter reversibile di nuova concezione realizzato in speciale lega di alluminio
- Pistoni guida in acciaio inox temprato
- Tappi speciali anti-polvere per salvaguardare i paraolio dei pistoni
- Sistema di tenuta olio a labirinto e o-ring tra carter e coperchio posteriore, per evitare fuoriuscite d'olio
- Visore livello olio di grandi dimensioni
- Bielle in speciale lega di alluminio realizzate in corpo unico
- Cuscinetti a sfera sovradimensionati di alta qualità per garantire una lunga durata
- Valvole di non ritorno in acciaio inox ad alta efficienza con tappi rimovibili per una facile ispezione
- Pistone tuffante in ceramica integrale, resistente alla corrosione e all'abrasione
- Sistema di guarnizioni a doppia tenuta ad elevate prestazioni
- Albero maschio 24 mm S per trasmissioni a cinghia, riduttori o giunti flessibili o motori elettrici albero cavo
- Facilita' di manutenzione grazie al ridotto numero di componenti facilmente accessibili
- vita utile abbondantemente sovradimensionata grazie ai carichi ridotti e al cinematismo nato per supportare i 280 bar.
- possibilita' versione inox con guarnizioni speciali resistenti all'attacco chimico



SYMMETRICAL - REVERSIBLE CARTER
CARTER SIMMETRICO - REVERSIBILE

Model	Version										
		mm	l/min	US gpm	bar	psi	rpm	HP	kW	kg	lb
EWM 0214	S	24	0,9	0,23	100	1450	1450	0,28	0,21	5,1	11,2
EWM 0514	S	24	2,1	0,54	100	1450	1450	0,58	0,43	5,1	11,2
EWMS 0214	S	24	0,9	0,23	100	1450	1750	0,28	0,21	5,1	11,2
EWMS 0514	S	24	2,0	0,54	100	1450	1750	0,56	0,42	5,1	11,2



MTP EWM

MEC80

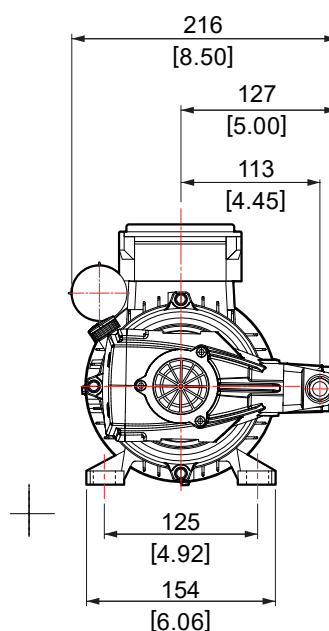
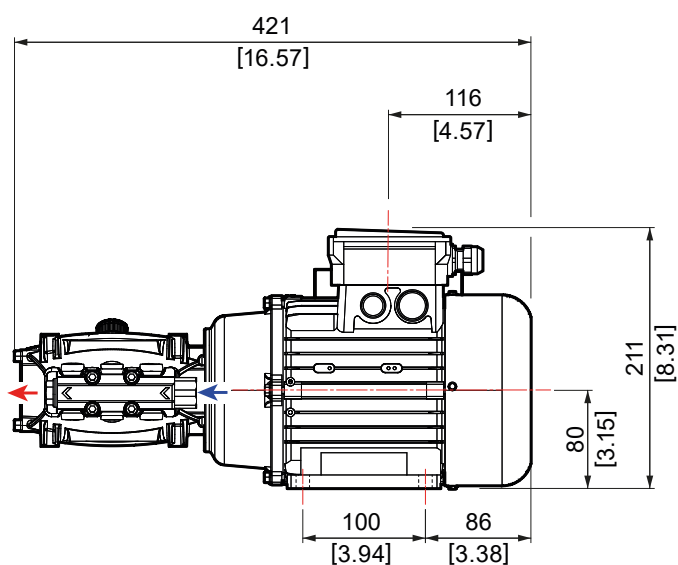
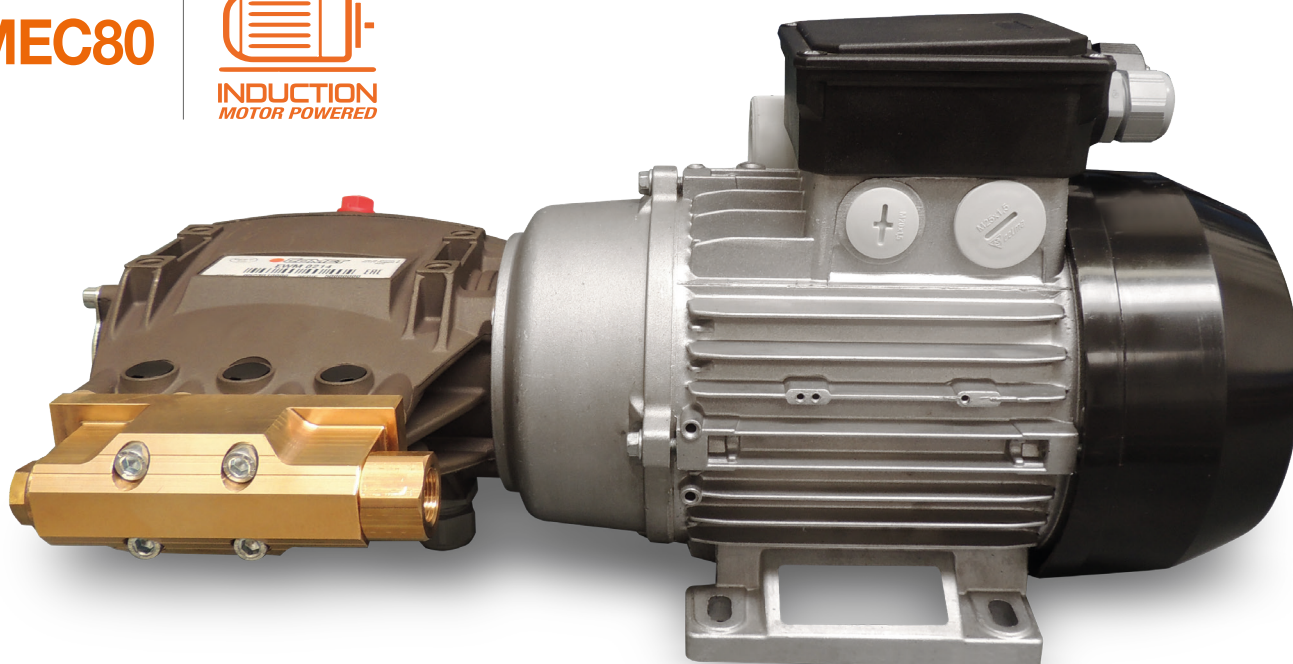
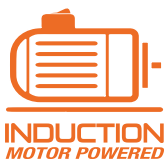

←	G3/8" - F
←	G1/4" - F

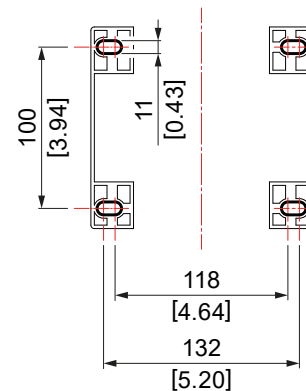

Code	Model													kg	lb
		rpm	l/min	US gpm	bar	psi	Mpa	Hz	V	HP	HP	kW	Mec		
7301 0973	MTP EWM 1/100	1450	0,9	0,23	100	1450	10	50	230 - 1	0,21	0,28	0,21	80	15	33,1
7301 0976	MTP EWM 2/100	1450	2,1	0,54	100	1450	10	50	230 - 1	0,43	0,58	0,43	80	15	33,1



ITALIAN EXCELLENCE



comet-spa.com

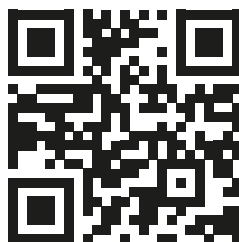

COMET SPA › Reggio Emilia › Italy › phone +39 0522 386111 › vendite@comet-spa.com › export@comet-spa.com › www.comet-spa.com

